

DD BOX PLUS 12/9 M6 0,76kW

GENERAL DATA

CENTRIFUGAL DIRECT DRIVE FAN WITH FORWARD CURVED IMPELLER IN SOUNDPROOF BOX WITH SANDWICH PANELS

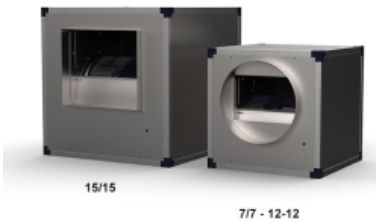

MANUFACTURING FEATURES

- Impellers made of polyamide reinforced with fibreglass.
- DD range fans assembled in soundproof cabinets.
- Structure profile made of aluminium 30 mm.
- Casing made of galvanized sandwich panel, with inner rock wool A1 class (100% noncombustible), density 90Kg/m3.
- Connection gland included.
- Easy access through lateral panel.
- Fan can be placed in any position by exchanging panels.
- Closed motors specially designed. Extruded aluminium motor housing. Totally enclosed wiring box IP-65. IP-54 motor protection and rated class F insulation. Standard voltages 230V 50Hz for single phase and 230/400V 50Hz for three phase motors.

APPLICATIONS

Designed for inline installation, indoor or outdoor assembly, they are suitable for:

- Air renewal in buildings and industries.
- Maximum working temperature: 50°C.

UNDER REQUEST

- 3 speed fans.
- Impeller made of galvanized sheet.

PERFORMANCE CURVE

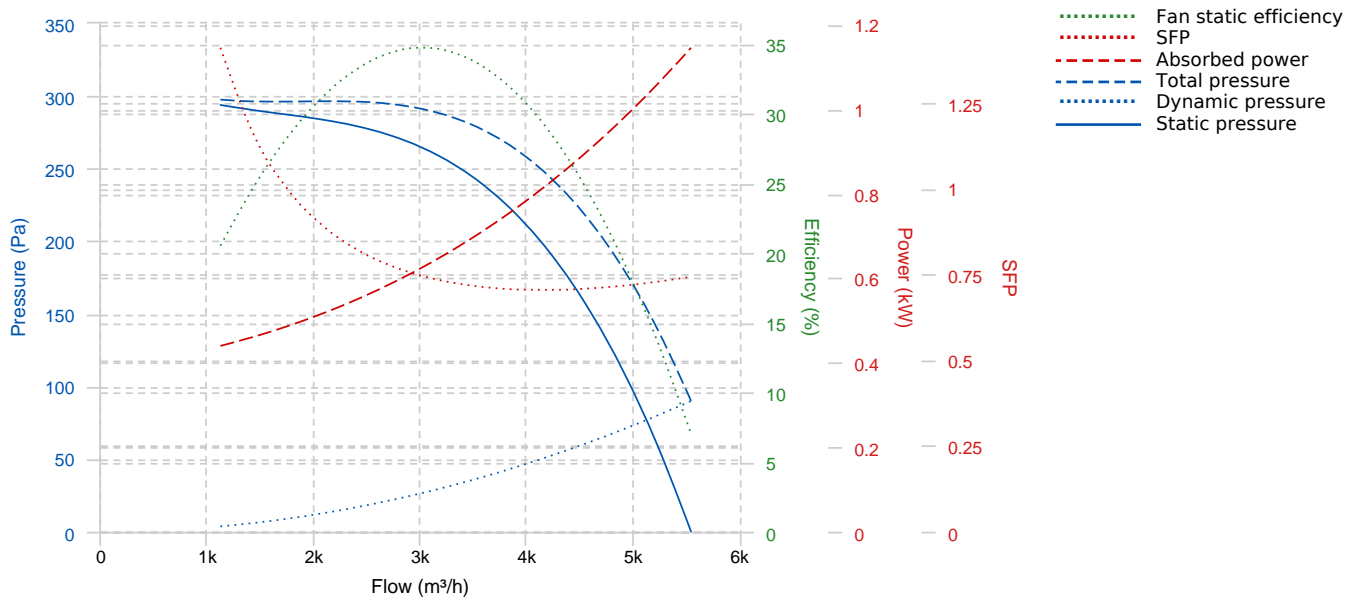

TECHNICAL DATA

Fan							
RPM	950	Approx. weight	51 kg	Max. Flow	5550 m³/h		
Motor							
Power	0,76 kW	RPM	950	Capacitor	30µF 400V	I max. (230V)	6,7 A

Motor

Size	STC90	Approx. weight	11.15 kg	Efficiency (%)	70 %	FP	0.96
------	-------	----------------	----------	----------------	------	----	------

DIMENSIONS

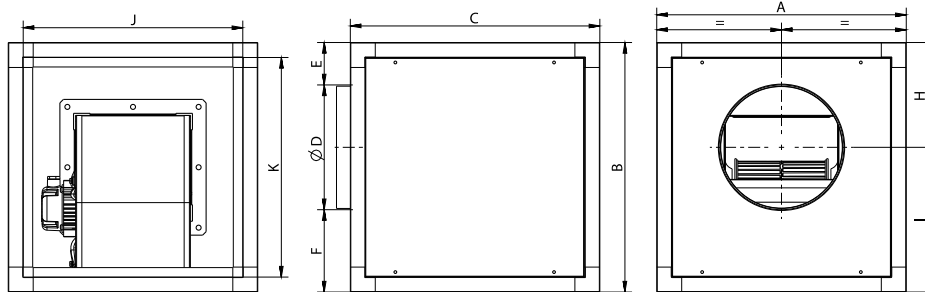

Dimensions (mm)

A	700	B	700	C	700	D	400	E	105
F	195	H	305	I	395	J	640	K	640

WIRING DIAGRAM

**SINGLE PHASE MOTOR
MOTOR MONOFÁSICO**

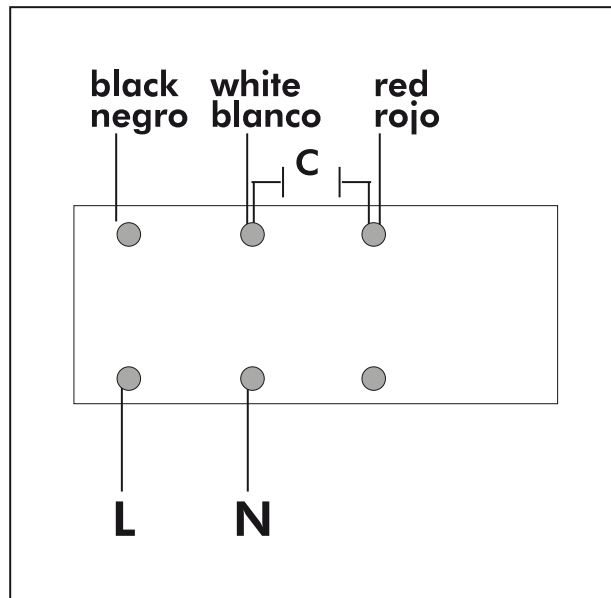

ACCESSORIES



**MANUAL SINGLE PHASE SPEED CONTROLLER
REG 10A**



**SAFETY SWITCH
INT 25 3P A**

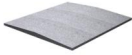

**WEATHER PROTECTIVE ROOF FOR VENTILATION
BOXES
TEJ BOX BD PLUS 12/12**



**EXTERNAL BOX FILTER
BOX FILTER 12**



**INLET/OUTLET ROUND COVER
TIAC BOX BD/BV PLUS 12/9 (Ø400)**

SPARE PARTS

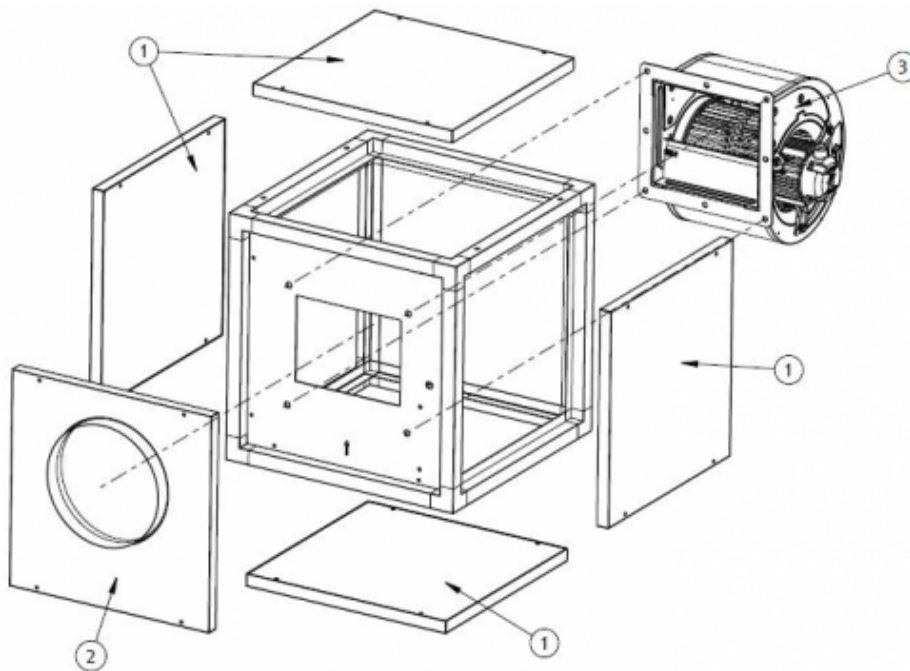

	Code	Model	Qty
1	R-251521931R	PANNEL BOX BD-BV PLUS 12/12	x4
3	251600261A002	FAN BD 12/9 M6 0,76kW+MBI	x1