

# BOX CAX 100 T6 (A6:3) Zone 2: FAN (Ex h IIB T3 Gc) + MOTOR (Ex ec IIC T3 Gc)

## GENERAL DATA



### ATEX AXIAL FAN WITH CAST ALUMINUM IMPELLER DIRECT DRIVE IN SOUNDPROOF CABINET

#### MANUFACTURING FEATURES

- BOX: Soundproof galvanised steel box with thermo-acoustic insulation, Bs1d0 fire class. Easy motor access and fan maintenance through removable panels.
- INSIDE FAN: For sizes from 45 to 80 we use model WMAX. For larger sizes from 90 to 125 we use model SCAX.
- Internal fan coil round frame reinforced with intermediate rib and sparking aluminum ring.
- Motor-impeller assembly through modular system.
- Cast aluminium impeller.
- Corrosion-resistant powder coat polyester resin.
- ATEX asynchronous squirrel-cage motor with IP-55 protection and class F insulation. Manufactured with standard voltages: 230/400V 50Hz in three phase motors up to 4kW and 400/690V 50Hz for higher powers.
- ATEX certified:
  - Motor Ex-d: II 3G EX-d IIC T4
  - Motor Ex-e: II 3G Ex-e IIC T4
  - Motor Ex-nA: II 3G/D Ex-nA IIC T3

#### APPLICATIONS

Designed for wall or duct installation, they are suitable for:

- Air renewal in buildings and industries.
- Smoke extraction (max 45-50°C).
- Ventilation in indoor environments classified as ATEX
- Maximum working temperature: 50°C

#### UNDER REQUEST

- B form or 100% reversible impeller.
- 60 Hz fans and special voltages.
- Atex classification for other areas.
- Bigger fan sizes.

## PERFORMANCE CURVE

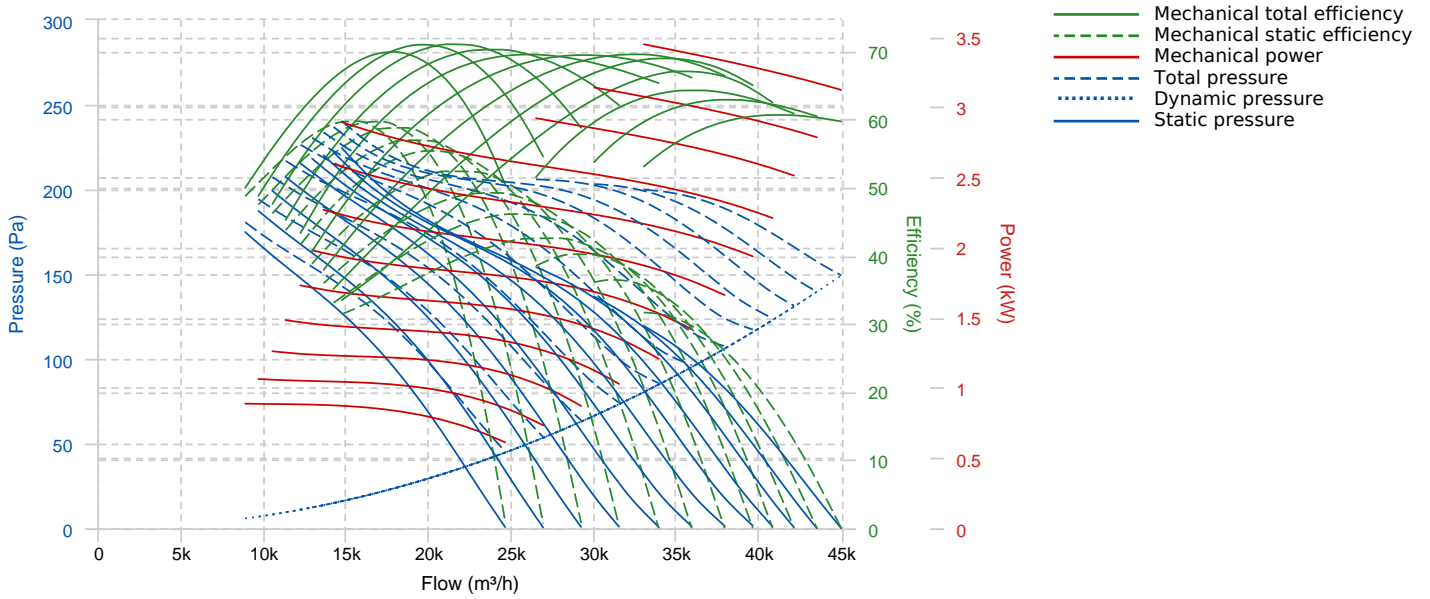

## TECHNICAL DATA

### Fan

RPM	-	Approx. weight	-	Max. Flow	44970 m³/h
-----	---	----------------	---	-----------	------------

## DIMENSIONS

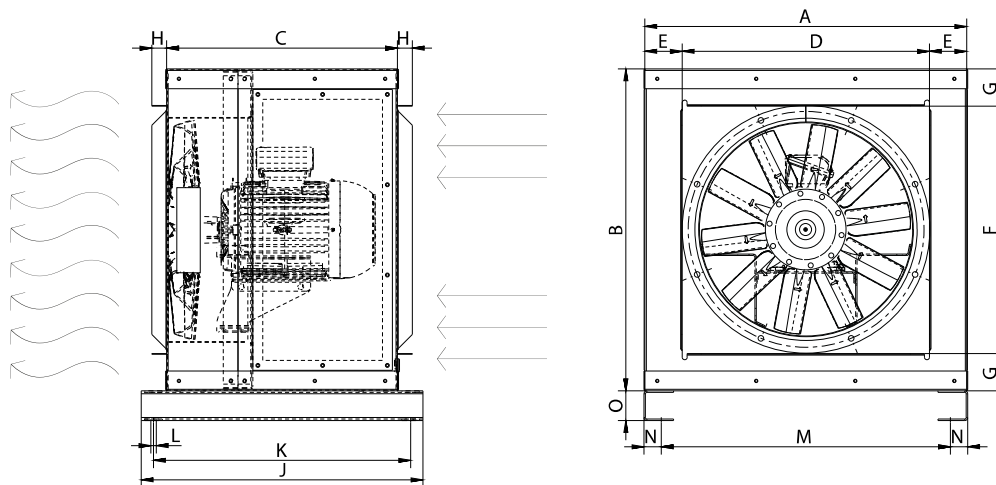

### Dimensions (mm)

A	1176.5	B	1176.5	C	857	D	1000	E	88
---	--------	---	--------	---	-----	---	------	---	----

### Dimensions (mm)

F	1000	G	88	H	30	J	965	K	915
L	11	M	1110	N	35	O	90		

### WIRING DIAGRAM

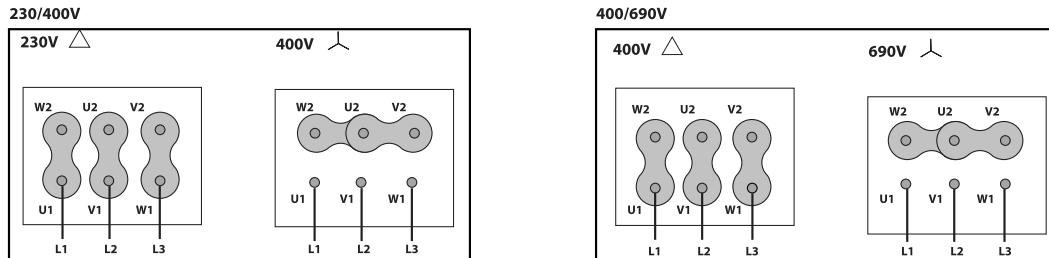

### ACCESSORIES



**FREQUENCY SPEED CONTROLLER  
SFC (GENERIC)**



**ANTI-VIBRATION SPRING BLOCK  
AVS (GENERIC)**