

BOX CAX FIRE 90 T6 (A3:8) F400

GENERAL DATA



AXIAL DIRECT DRIVE ATEX SMOKE FAN WITH CAST ALUMINUM IMPELLER IN SOUNDPROOF CABINET - ATEX 400°C/2H

MANUFACTURING FEATURES

- BOX: Manufactured in galvanised steel sheet with thermalproofing. Soundproofing cabinets with thermo-acoustic insulation, Bs1d0 fire class. Removable panels for easy motor access and fan maintenance.
- INSIDE FAN: For sizes from 45 to 80 we use model WMAX FIRE (F400+ATEX). For larger sizes from 90 to 125 we use model SCAX FIRE (F400+ATEX).
- Modular motor-impeller assembly.
- Cast aluminum impeller with variable pitch angle.
- Polyester powder finishing coat.
- Standard asynchronous squirrel-cage motor with IP-55 protection and Class H insulation certified 400°C/2H and ATEX. Manufactured with standard voltages: 230/400V 50Hz in three phase motors, up to 4kW and 400/690V 50Hz for higher powers.
- ATEX certified II 3G EX-ed IIC T3 Gc & II 3D EX-tc IIB T125 Dc

APPLICATIONS

Designed for wall or duct installation, they are suitable for:

- Smoke emergency exhaust with motor inside the hazardous area.
- Cabinet design simplifies installation in rectangular duct systems.
- Maximum working temperature: 60°C.

UNDER REQUEST

- Supply 100% reversible impeller.

Official homologation by the European laboratory APPLUS according to EN 12101-3:2015 Certification Nr: 0370-CPR-2272

PERFORMANCE CURVE

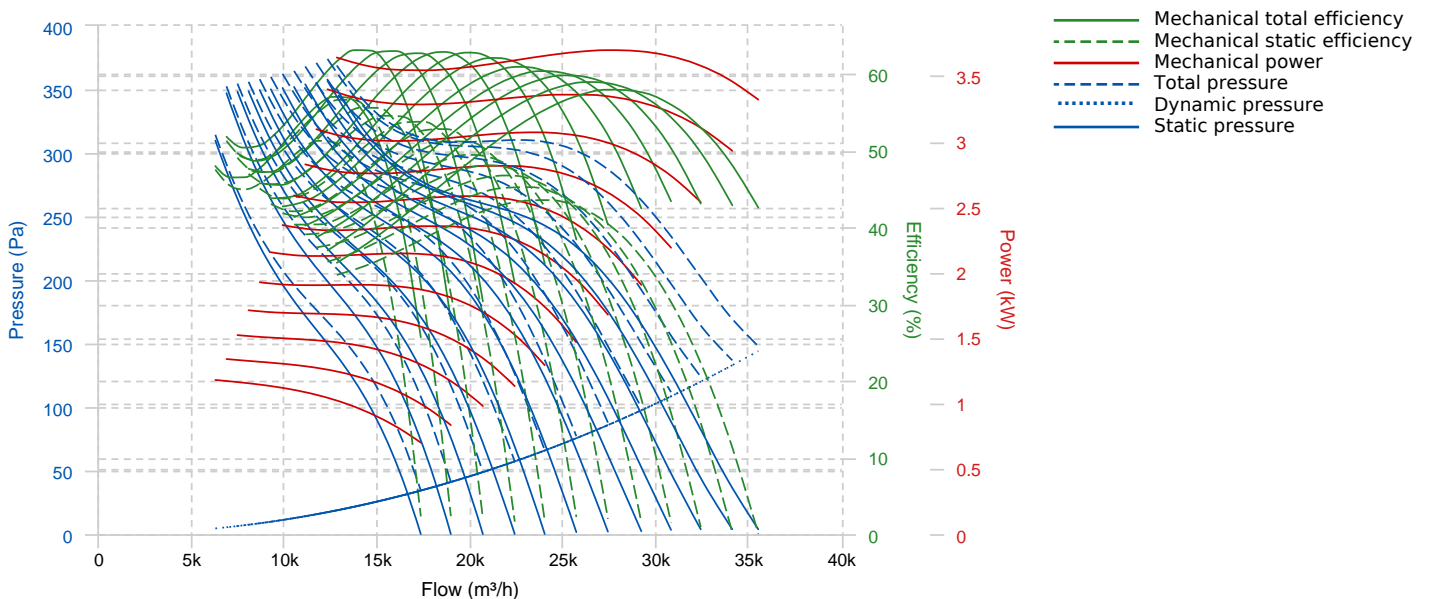

TECHNICAL DATA

Fan

RPM	-	Approx. weight	-	Max. Flow	35510 m ³ /h
-----	---	----------------	---	-----------	-------------------------

DIMENSIONS

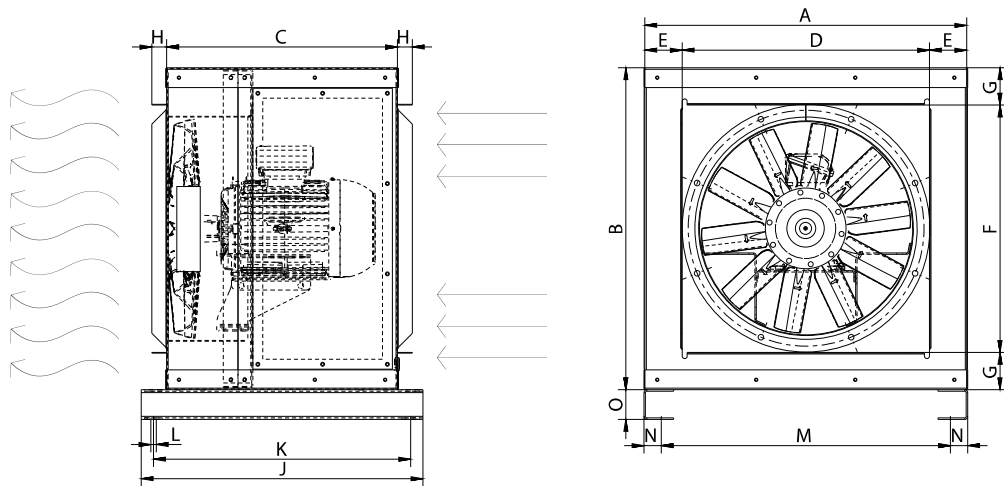

Dimensions (mm)

A	1176.5	B	1176.5	C	857	D	1000	E	88
F	1000	G	88	H	30	J	965	K	915
L	11	M	1110	N	35	O	90		

WIRING DIAGRAM

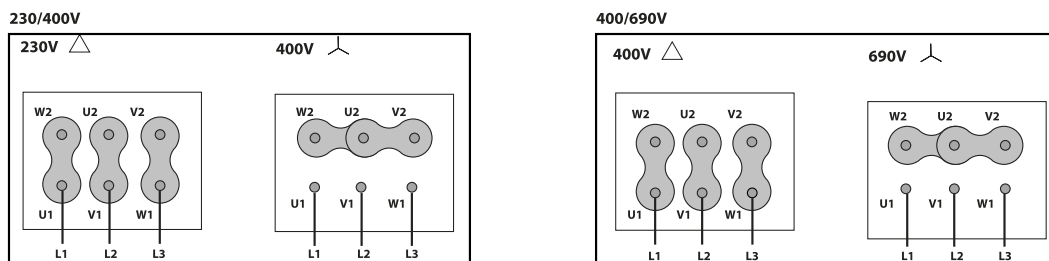

ACCESSORIES



**FREQUENCY SPEED CONTROLLER
SFC (GENERIC)**



**SAFETY SWITCH
INT (GENERIC)**



**SAFETY SWITCH FOR 400°C/2h
INT F400 (GENERIC)**



**ANTI-VIBRATION SPRING BLOCK
AVS (GENERIC)**