

## BOX CA 80 T6 (A5:6)

### GENERAL DATA



#### AXIAL DIRECT DRIVE FAN WITH CAST ALUMINUM IMPELLER IN SOUNDPROOF CABINET

##### MANUFACTURING FEATURES:

- BOX: Soundproof galvanised steel box with thermo-acoustic insulation, Bs1d0 fire class. Easy motor access and fan maintenance through removable panels.
- INSIDE FAN: For sizes from 45 to 80 we use model WMA. For larger sizes from 90 to 125 we use model SCA.
- Modular motor-impeller assembly.
- Cast aluminum impeller with variable pitch angle.
- Polyester powder finishing coat.
- Squirrel cage asynchronous standard motor, IP-55 protection and rated class F insulation. Standard voltages 230V 50Hz for single phase motors, 230/400V 50Hz for three phase motors up to 4kW and 400/690V 50Hz for higher powers.

##### APPLICATIONS:

Designed for wall or duct installation, they are suitable for:

- Air renewal in buildings and industries.
- Smoke extraction (max 45-50°C).
- Maximum working temperature: 1ph 50°C, 3ph 60°C.

##### AVAILABLE ON REQUEST:

- Reversible impeller.
- B form impeller (airflow from impeller to motor)
- 60Hz fans and special voltages.

### PERFORMANCE CURVE

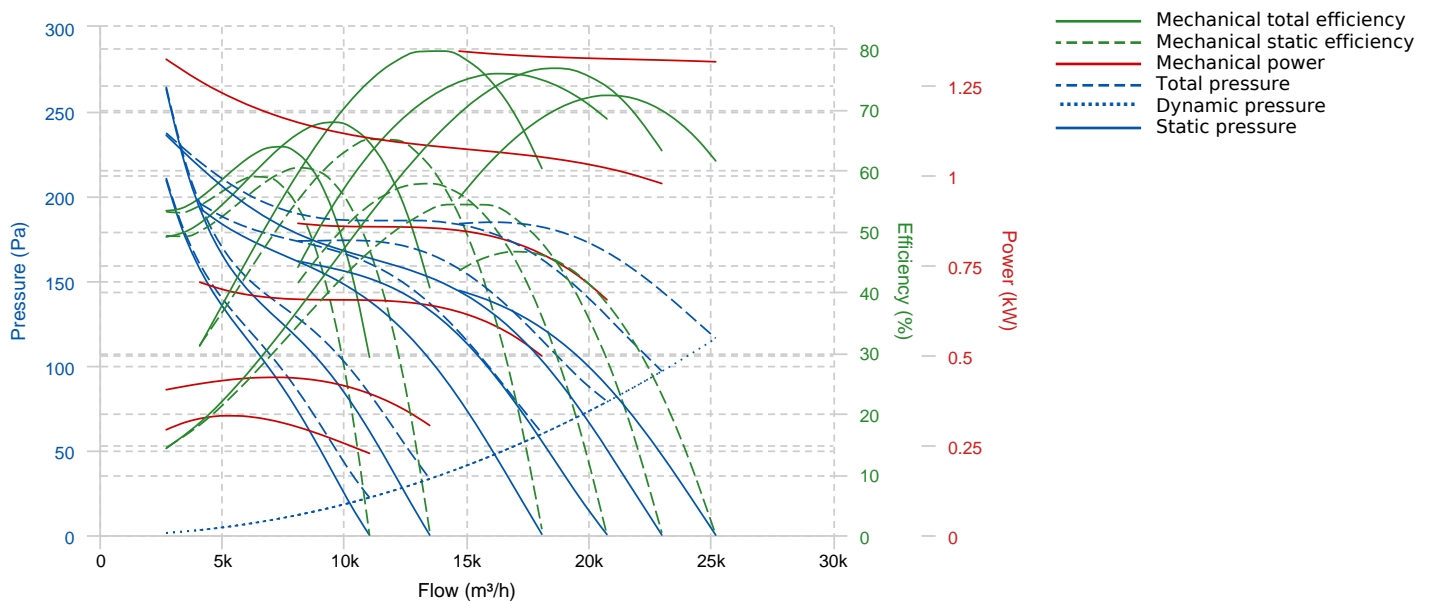

## TECHNICAL DATA

### Fan

RPM	-	Approx. weight	-	Max. Flow	25190 m <sup>3</sup> /h
-----	---	----------------	---	-----------	-------------------------

## DIMENSIONS

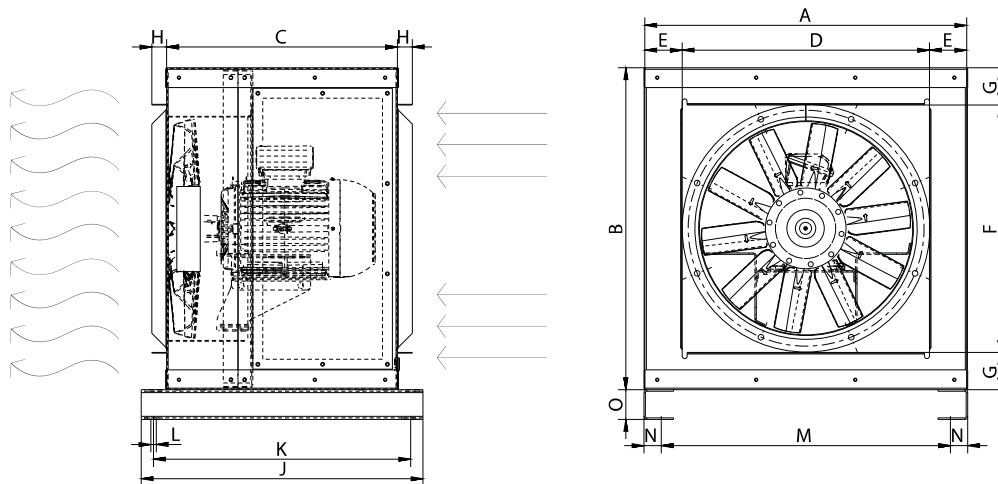

### Dimensions (mm)

A	951.5	B	951.5	C	597	D	800	E	76
F	800	G	76	H	30	J	705	K	650
L	11	M	885	N	35	O	60		

## WIRING DIAGRAM

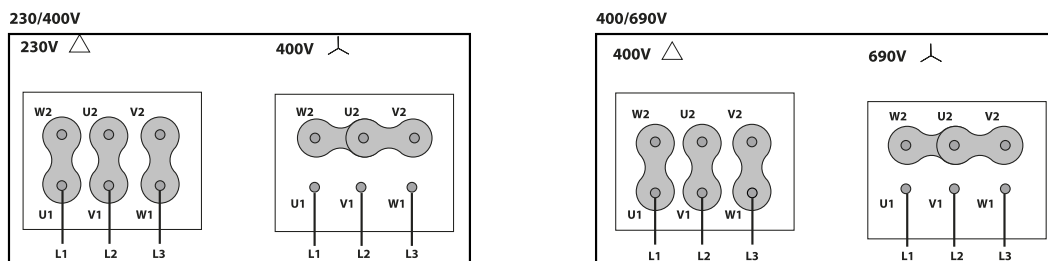

## ACCESSORIES



**FREQUENCY SPEED CONTROLLER  
SFC (GENERIC)**



**SAFETY SWITCH  
INT (GENERIC)**



**ANTI-VIBRATION SPRING BLOCK  
AVS (GENERIC)**