

BOX CA FIRE 56 T4 (A5:6) F400

GENERAL DATA



AXIAL DIRECT DRIVE SMOKE FAN WITH CAST ALUMINUM IMPELLER IN SOUNDPROOF CABINET - 400°C/2H

MANUFACTURING FEATURES

- **BOX:** Manufactured in galvanised steel sheet with thermalproofing. Soundproofing cabinets with thermo-acoustic insulation, Bs1d0 fire class. Removable panels for easy motor access and fan maintenance.
- **INSIDE FAN:** For sizes from 45 to 80 we use model WMA Fire F400. For larger sizes from 90 to 125 we use model SCA FIRE F400.
- Modular motor-impeller assembly.
- Cast aluminum impeller with variable pitch angle.
- Polyester powder finishing coat.
- Standard asynchronous squirrel-cage motor with IP-55 protection and Class H insulation certified 400°C/2H. Manufactured with standard voltages: 230/400V 50Hz in three phase motors up to 4kW and 400/690V 50Hz for higher powers.

APPLICATIONS

Designed for wall or duct installation, they are suitable for:

- Smoke emergency exhaust with motor inside the hazardous area.
- Cabinet design simplifies installation in rectangular duct systems.
- Maximum working temperature: 60°C.

UNDER REQUEST

- Supply 100% reversible impeller.

Official homologation by the European laboratory APPLUS according to EN 12101-3:2015
Certification Nr: 0370-CPR-2272

PERFORMANCE CURVE

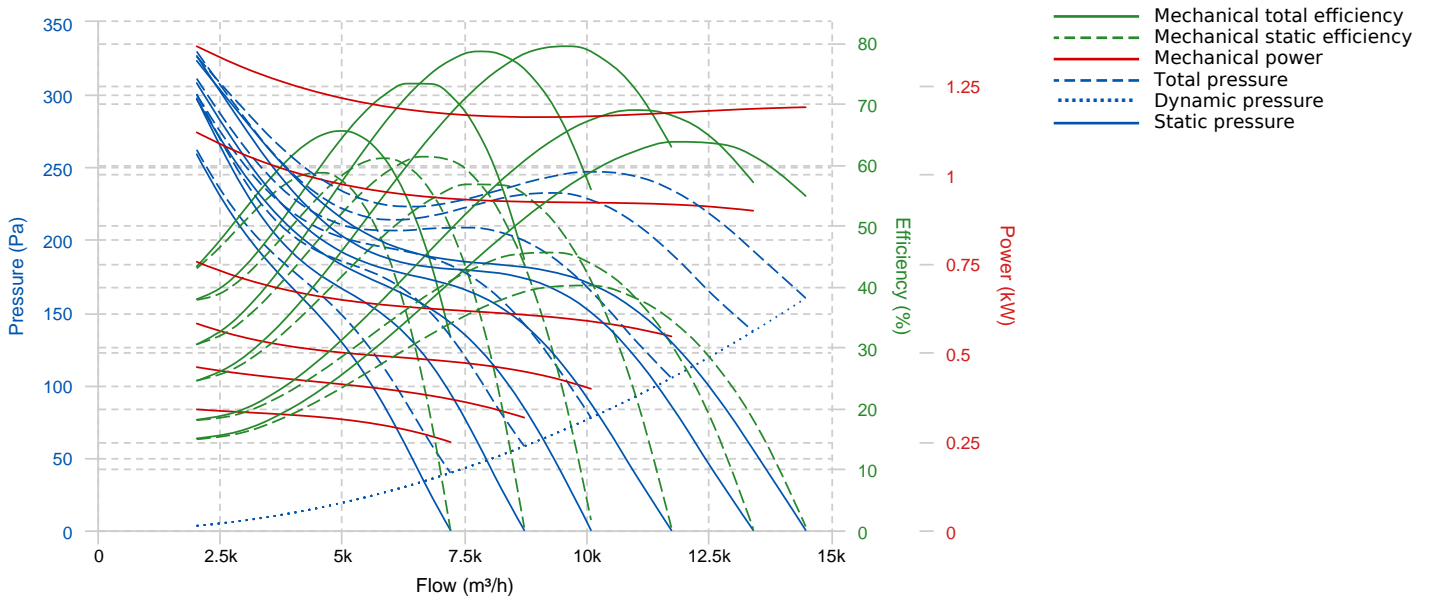

TECHNICAL DATA

Fan

RPM	-	Approx. weight	-	Max. Flow	14480 m³/h
-----	---	----------------	---	-----------	------------

DIMENSIONS

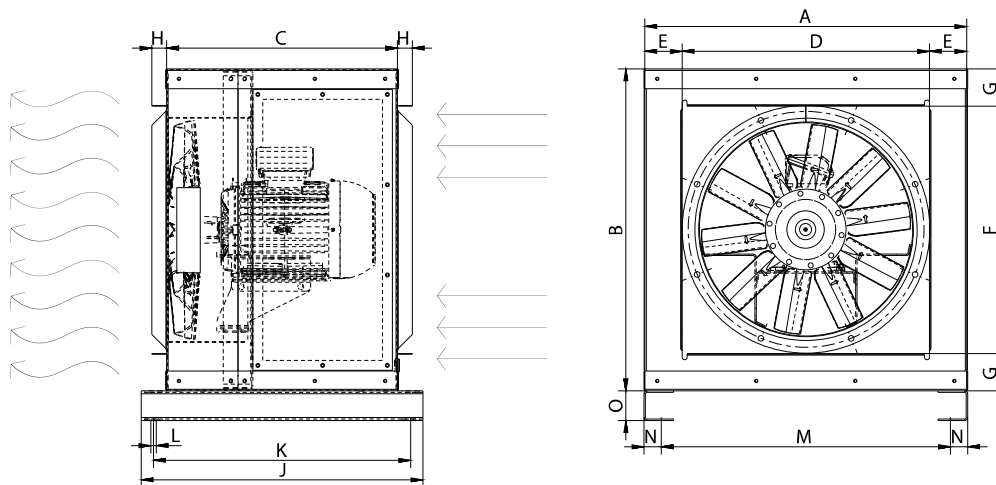

Dimensions (mm)

A	781.5	B	781.5	C	542	D	630	E	76
---	-------	---	-------	---	-----	---	-----	---	----

Dimensions (mm)

F	630	G	76	H	30	J	665	K	610
L	11	M	715	N	35	O	60		

WIRING DIAGRAM

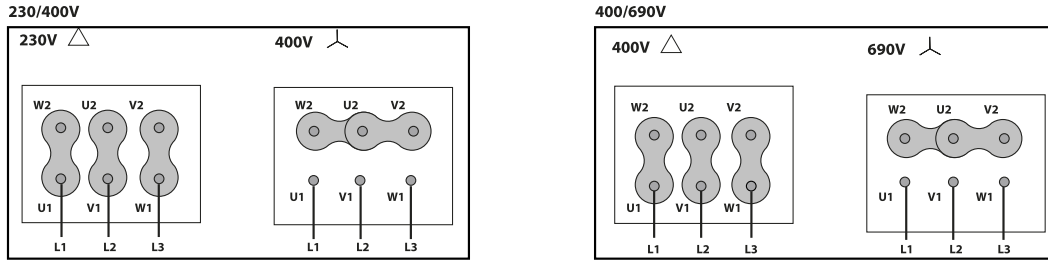

ACCESSORIES



FREQUENCY SPEED CONTROLLER SFC (GENERIC)



SAFETY SWITCH INT (GENERIC)



SAFETY SWITCH FOR 400°C/2h INT F400 (GENERIC)



ANTI-VIBRATION SPRING BLOCK AVS (GENERIC)