

RP 90 ()

GENERAL DATA



PROTECTION GUARD FOR LONG CASE FANS

CONSTRUCTION FEATURES

- Protective grille on the motor and propeller side to prevent objects from entering. For SCAP and SCA models, the RP grille is only applicable on the propeller side. The RP is also suitable for the HMR EVO range, both for intake and discharge (note that the grille is of different sizes depending on whether it is for intake or discharge)
- Constructed with electro-welded rod.
- Compliant with ROHS directive 2002/95/EC.

ON REQUEST

- Grille in 304 or 316 stainless steel with electropolished finish.

TECHNICAL DATA

approx. weight	3.50 Kg
----------------	---------

DIMENSIONS

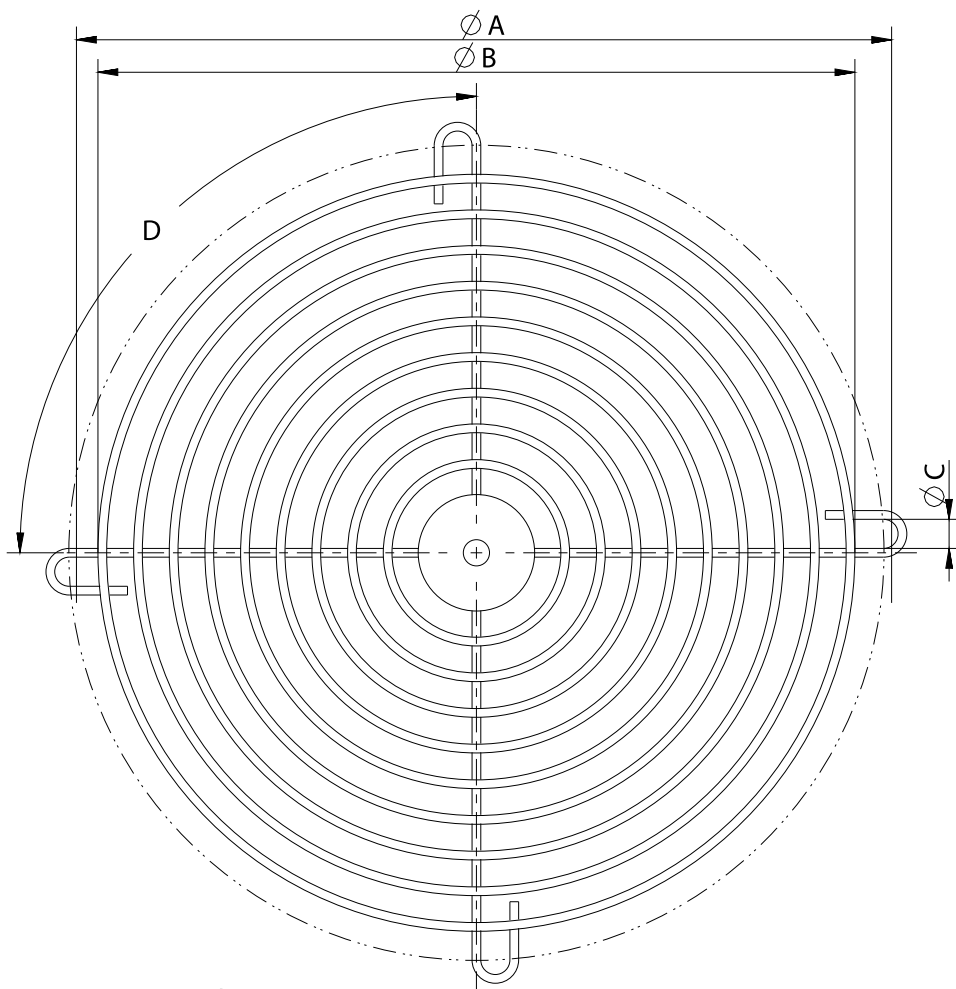

NOTA: Cota maxima entre barillas 10mm.

Dimensions (mm)

D	8x45°	$\varnothing A$	970	$\varnothing B$	935	$\varnothing C$	10
---	-------	-----------------	-----	-----------------	-----	-----------------	----