

## SILC-MINI 450 ( )

### GENERAL DATA

#### CIRCULAR SOUND ATTENUATOR IN GALVANISED STEEL

The sound attenuators are used to absorb the noise in air conditioning or ventilation ducts.

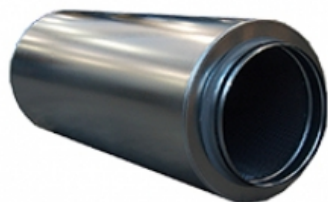

Casing in galvanised steel, thickness 0,8 mm;  
Mounting flange with quick attack;  
Acoustic material in mineral wool 50 Kg /m<sup>3</sup> with protection against erosion by glass fibre  
fire resistance M0 and extended metal sheet

UNDER REQUEST:

Stainless steel execution

### TECHNICAL DATA

approx. weight 28.00 Kg

### DIMENSIONS

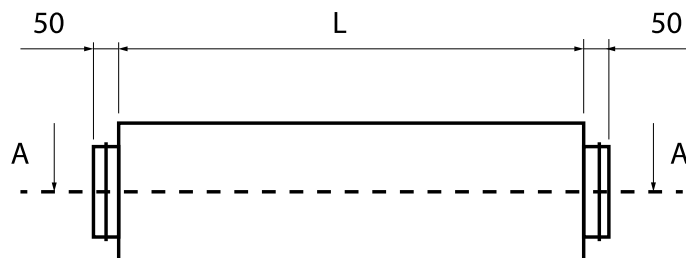

SEZ. A-A

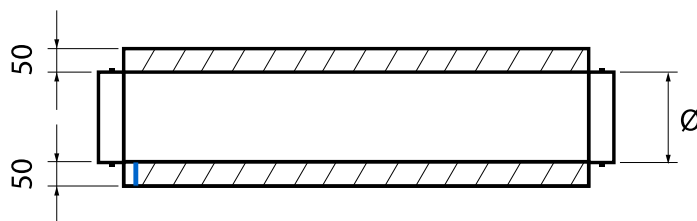

#### Dimensions (mm)

L	900	Ø	448
---	-----	---	-----